

# AMP4IC6

## FOUR INPUT/SOURCE SELF-AMPLIFIED SPEAKER

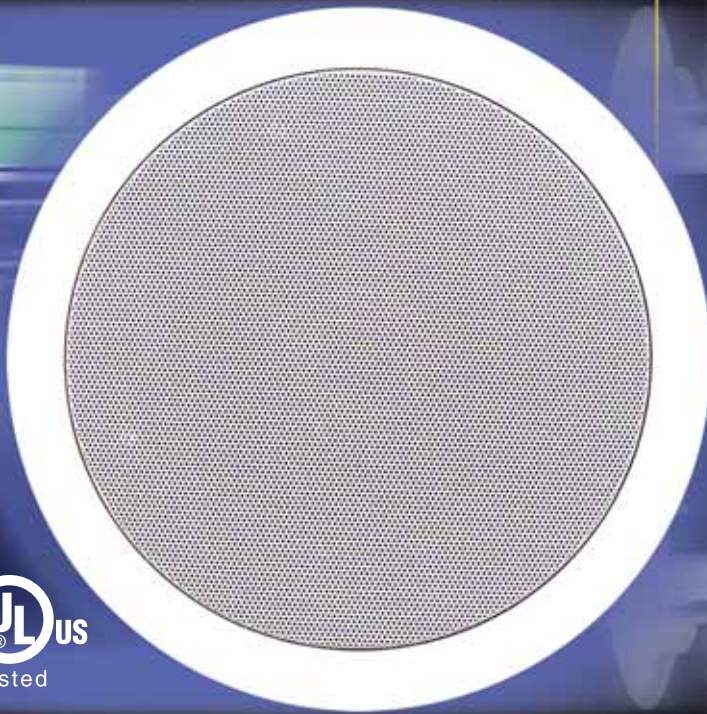

**NON-AMPLIFIED SPEAKERS**



**LINE LEVEL  
VOLUME CONTROL**



### AMP4IC6

- Built on to the OWI IC6 In-ceiling speakers
  - 4 line level inputs/sources
- Can effectively drive up to three additional non-amplified Model IC6 speakers
  - Up to 4 amplified speakers on one line
- Up to 25 watts of class AB power right at the speaker
  - Lower noise feature
  - Fast and easy install in the field
- 12 volt AC power supply (UL rated) included
  - Protected from shorts and overheating
  - Line level volume control available
- Speaker combination program available



**Video Projector**



**Wireless Microphone**



**Computer**



**MP3 Player**



**CD Player**



**DVD Player**



# AMP41C6

ARCHITECTS AND ENGINEERS  
SPECIFICATIONS/TECHNICAL DATA

## SELF-AMPLIFIED SPEAKER (4 INPUT/SOURCE) TO ANOTHER SELF-AMPLIFIED SPEAKER WIRING DIAGRAM

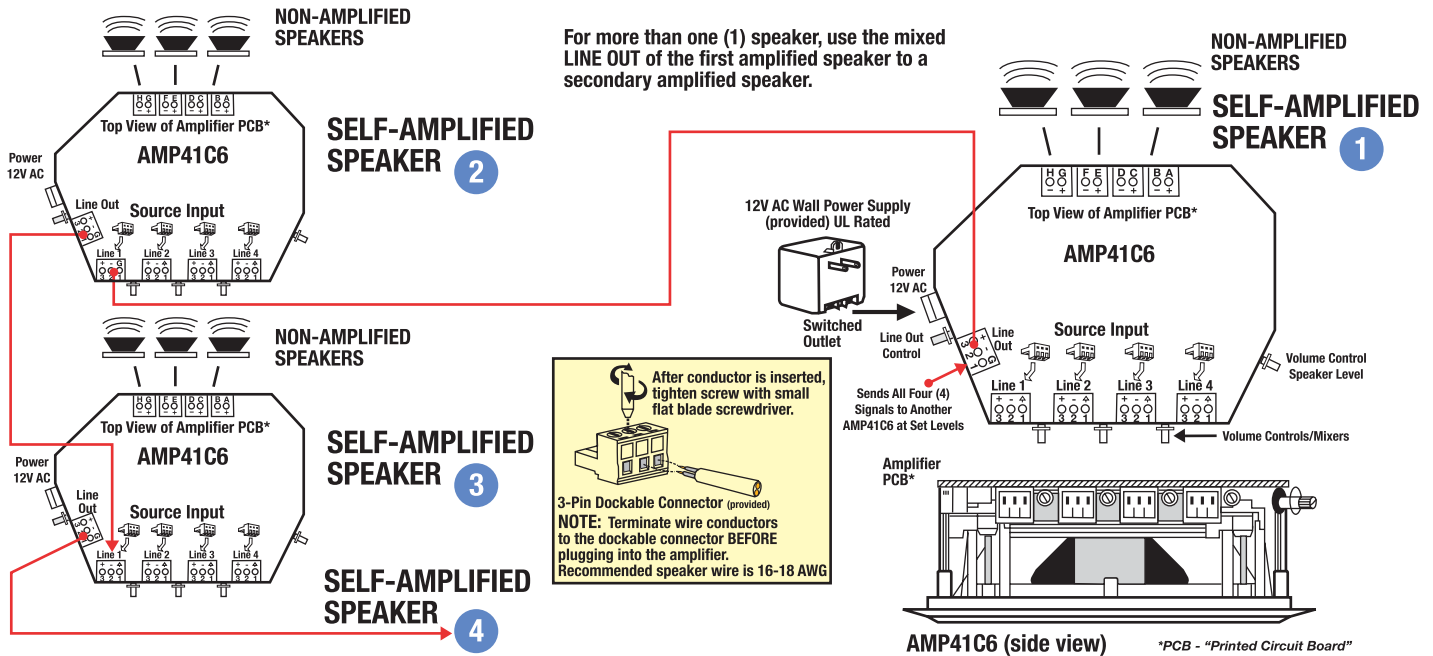

## GENERAL SPECIFICATIONS:

### Frequency Response

Total Harmonic Distortion (THD)

Signal to Noise Ratio (S/N)

Input Configuration

Minimum Common Mode Rejection

Maximum Power Output

At Load Impedance

Minimum Power Supply Voltage

Maximum Supply Voltage

Maximum Current Protected

Short Circuit Protected

One Wire to Ground Protected

Minimum Load Impedance

Input Load Impedance

Maximum no. of Amplifiers on one line

Power Supply

Inputs

Outputs

Controls

### Outputs

Heat Sink

High Voltage

Protection

Plastic

Available Backcan (sold separately)

Warranty

50 Hz to 15kHz. HF is optimized to enhance frequency response of the speaker.

<.1%

>90dB

Differential (noise reducing)

40dB

25 watts

4 Ohms (2 speakers in parallel or 4 speakers in series parallel)

8 Volts

14 Volts

Yes

Yes

Yes

3.2 Ohm

10K Ohm

4

12 Volts AC 12- 14V AC

4 Balanced Line

1 Balanced Line

4 Input Level Controls

1 Line Out Level Control

1 Amplifier Gain Control

4 Output Jacks allowing automatic correct wiring for series parallel

connection by simply plugging each speaker into its jack.

An Oversize Heat-Sink is provided

The highest voltage on the PCB is 12 Volts

The amplifier is protected against short and overheating

Fire rated V-0

UL Listed and Plenum Rated

1 year



## RECOMMENDED ACCESSORIES



Backcan (BC)  
UL Listed  
Plenum Rated  
Enclosure Backcan  
Required as per  
UL Standard



Mono (AMP-MOVC)  
Stereo (AMP-STVC)  
Line Level Volume Control



Tile Bridge  
Model 6TB



Stereo Combiner  
(AMPSTCOMB)



**OWI Incorporated**

17141 Kingsview Avenue  
Carson, CA 90746 USA

ph. 310.515.1900 800.638.1694  
fx. 310.515.1606 e. info@owi-inc.com  
www.owi-inc.com

ESTABLISHED 1978